

## **DIGITAL WIRELESS TV HEADSET SOUNDS**

(Product can support 2 Headsets)



# Contents

!!!Please ensure you read the user manual thoroughly before use!!!

!!!Please refer to our website: [www.geemarc.com](http://www.geemarc.com) for an up to date user guide, as there may be important updates and changes you need to be aware of !!!

<b>INTRODUCTION</b> .....	<b>3</b>
 <b>SAFETY &amp; CARE ADVICE</b> .....	<b>5</b>
<b>PACK COMPONENTS</b> .....	<b>6</b>
<b>FUNCTION IDENTIFICATION</b> .....	<b>7</b>
• Function Identification: Headset Receiver .....	7
• Function Identification: Charging Cradle .....	9
<b>INSTALLATION</b> .....	<b>10</b>
• Transmitter .....	10
• Headset .....	11
<b>OPERATION</b> .....	<b>12</b>
• Initial Operation .....	12
• Routine Operation .....	12
• Controlling the Tone (Bass & Treble) .....	14
• Adjusting the Sound Balance (left-right) .....	14
• Using the Mute Button and Microphone for Conversation .....	15
• Charging the Battery .....	15
• Pairing extra headsets .....	16



<b>TROUBLESHOOTING .....</b>	<b>18</b>
• No Sound .....	18
• Distortion .....	18
<b>Cleaning &amp; Maintenance .....</b>	<b>19</b>
<b>Spare/replacement parts .....</b>	<b>19</b>
<b>Customer support .....</b>	<b>19</b>
<b>GUARANTEE .....</b>	<b>20</b>
<b>UKCA DECLARATION .....</b>	<b>20</b>
 <b>BATTERY WARNINGS .....</b>	<b>20</b>
<b>DISPOSAL INFORMATION .....</b>	<b>21</b>
<b>FEATURES .....</b>	<b>21</b>
<b>TECHNICAL SPECIFICATIONS .....</b>	<b>22</b>

# INTRODUCTION

## INTRODUCTION

---

The Geemarc Digital Wireless Audio Listener is an audio amplification system specifically designed for people with hearing difficulties.

The Geemarc Audio Listener can be used with all kinds of audio systems for interference-free listening enjoyment – **TV set, Smartphone, DVD player, CD player, Hi-Fi system, iPod or other.**

Audio output from a TV or audio device is transmitted by the Charging Cradle(Base), the wireless Headset receives the signal and amplifies the audio sound for the listener.

One Base can be paired with up to 4 Headsets.

One Base can support 2 Headsets for charging.

The listener's comfort and long-term enjoyment has been built into every feature of the Geemarc Wireless Audio Listener:

- Lightweight wireless headset fitted with soft silicone ear buds for prolonged listening comfort;
- Rich, adjustable audio quality:
  - Broad audio bandwidth, High quality sound.
  - Adjustable EQ and balance to compensate for hearing loss.
- Listen but keep in touch with your surroundings:
  - Multiple Headsets can be paired with one Charging Cradle;
  - Single-touch Mute function switches the Audio Listener into a conversation assistant enabling you to talk with and listen to the people around you with the Headset on, taking advantage of its built-in audio amplifier to hear everything better.

- Up to 6 hours of rechargeable battery life per full charge – never lose the soundtrack in mid-program;
- Only 3 hours to fully recharge the Headset simply by replacing the Headset in its Charging Cradle.
- Auto Power OFF Headset simply by replacing the Headset in its Charging Cradle.
- Auto Power ON Headset simply by taking the Headset from its Charging Cradle in the 5 minutes.

## **IMPORTANT NOTICES:**

This series of CL7370 products comes in 2 models variations and extra headsets as below and this Instruction Manual covers all of them.

1. CL7370\_Analogue Version: the one only with analogue audio input.
2. CL7370\_Optical Version: the one with both analogue audio input and Optical digital audio input.
3. CL7370 extra Headsets. Please refer to the section “Pairing extra headsets” for special operation.

# SAFETY & CARE ADVICE



## SAFETY & CARE ADVICE

---

To make the best use of this product and to use it safely, please read these instructions thoroughly before use and keep safe for future reference.

**Warning:** This product can be very loud. Take care to prevent others from using this product, if they do not have the same level of hearing loss. Excessive sound pressure from earphones and headphones can cause hearing loss.

**Caution: Electric shock. DO NOT** insert unattached plug heads in to mains power sockets. Plug heads **MUST** be fitted to the power adaptor.

**Electrical connection:** The unit is designed to operate from a 100-240VAC - 50/60Hz supply. (Classified as 'hazardous voltage' according to EN 62368-1 standard).

**Caution: Batteries should only be replaced by Geomarc or authorised Vendor. Please refer to the chapter: <Spare / replacement parts> for more information.**

Keep the unit away from heat sources.



**DO NOT** expose the unit to direct sunlight.

Do not expose the Headset, which contains batteries, to excessive heat such as sunshine, fire etc.

Clean the Headset and ear pads regularly. For details on cleaning, please refer to the chapter: **<Cleaning & Maintenance>**.

**DO NOT** modify the unit in any way.

**Please note :** The unit may be subject to interference from appliances that generate strong electrical or magnetic fields e.g. wireless Internet routers, microwaves, mobile phones, lighting transformers etc. To avoid this interference, place the Charging Cradle unit away from such sources.

# PACK COMPONENTS

## PACK COMPONENTS

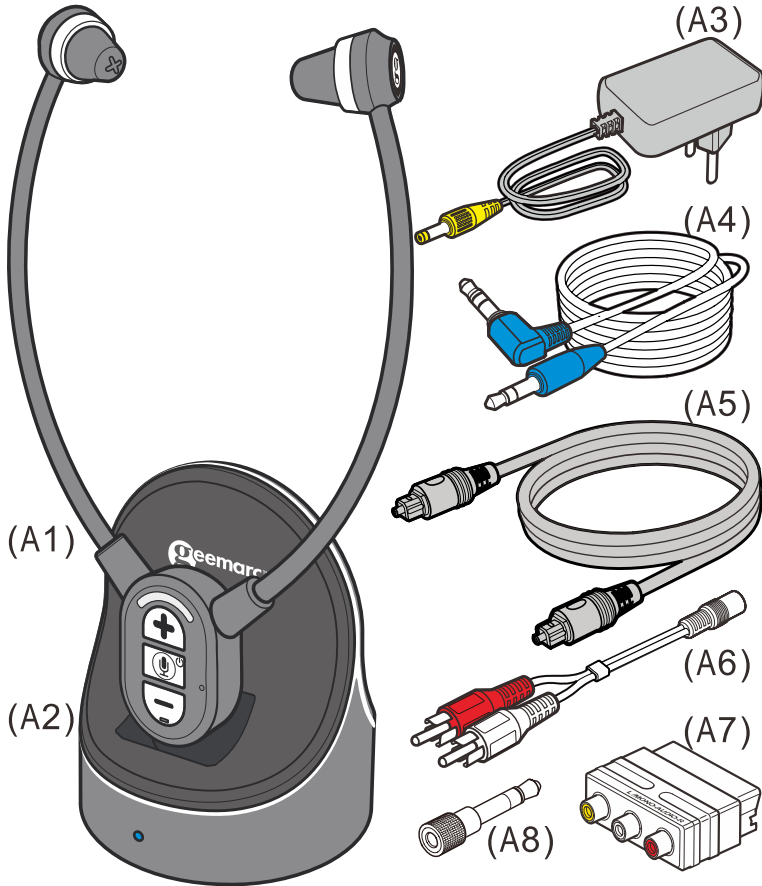

(A1) Headset Receiver

(A2) Charging Cradles and Transmitter

(A3) Power Supply

(A4) Audio Cable (both ends with 3.5 mm stereo plug)

(A5) Toslink Cable for Optical Digital Audio Connection (Optical version only). **IMPORTANT: Before using the cable remove the clear plastic protective covers from both ends.**

(A6) 3.5mm to 2 pin RCA Adapter Cable (**Optional**)

(A7) SCART Adapter (Only for the analog version) (**Optional**)

(A8) 3.5 mm to 6.3 mm Adapter Plug (**Optional**)

# FUNCTION IDENTIFICATION

## FUNCTION IDENTIFICATION

### Function Identification: Headset Receiver

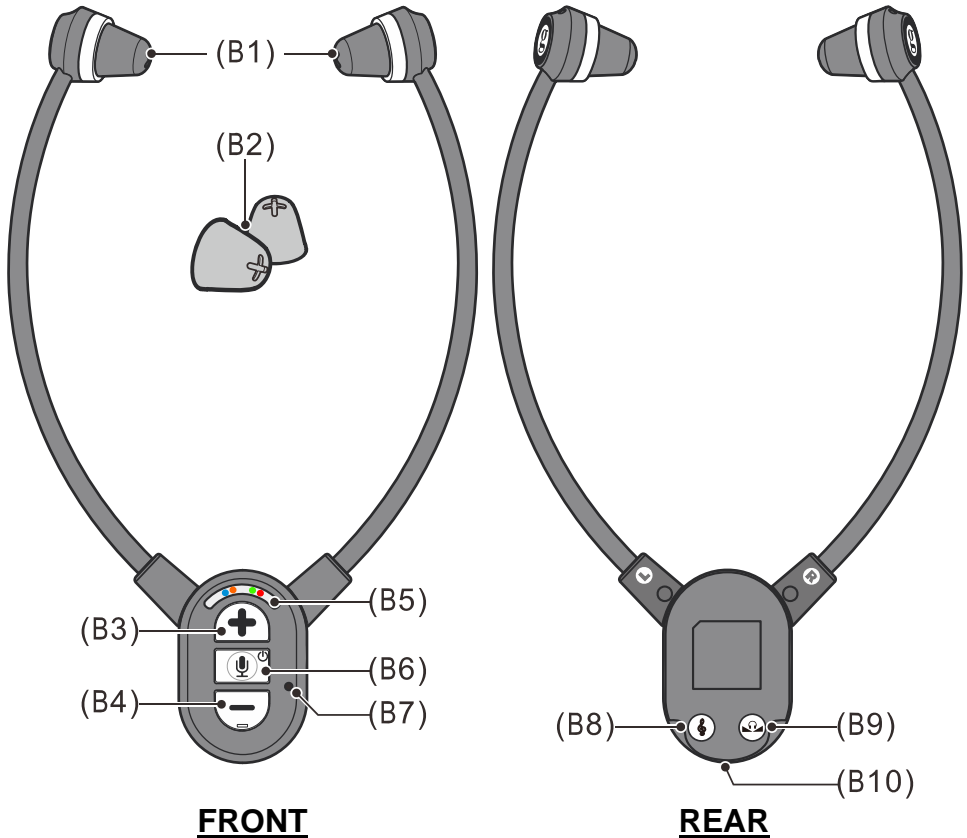

(B1) Earbuds

(B2) Spare ear tips. There are 2 styles of ear tip.

(B3) Volume Increase Control, Balance Control

(B4) Volume Decrease Control, Balance Control

(B5) Power/Signal/Charging/Local Microphone LED Indicators:

- Battery Charge (**Red** = charging, **Green** = fully charged)
- LED Indicator (**Orange**): Local Microphone Amplification for Verbal Communications.
- LED Indicator (**Blue lights up**): Paired with Transmitter.



# FUNCTION IDENTIFICATION

- LED Indicator (**Blue Slow flashing**): Not Paired with Transmitter, or Transmitter is powered off.
- LED Indicator (**Blue Fast flashing**): in Pairing Mode.

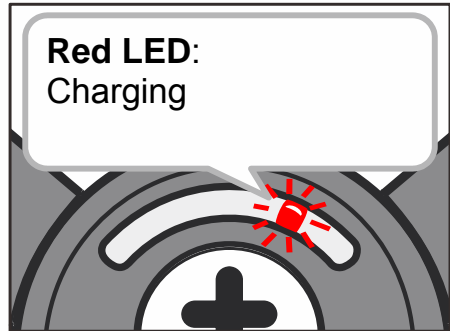
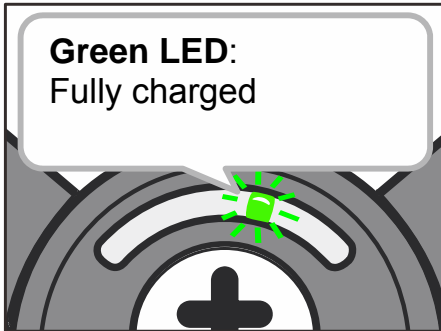
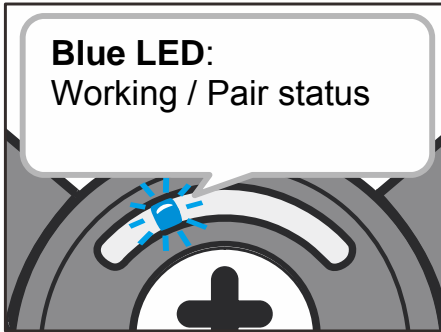

(B6) Power Button and Mute Button for Verbal Communications

- Long press to Power OFF headset.
- Short press to Power ON headset.
- Short press to switch between wireless TV listening and Local Microphone amplification for Verbal Communications.

(B7) Microphone

(B8) Tone Adjustment

(B9) Sound Balance Control

(B10) Load Contacts

# FUNCTION IDENTIFICATION

## Function Identification: Base Charging Cradles(Transmitter)

### FRONT

### REAR

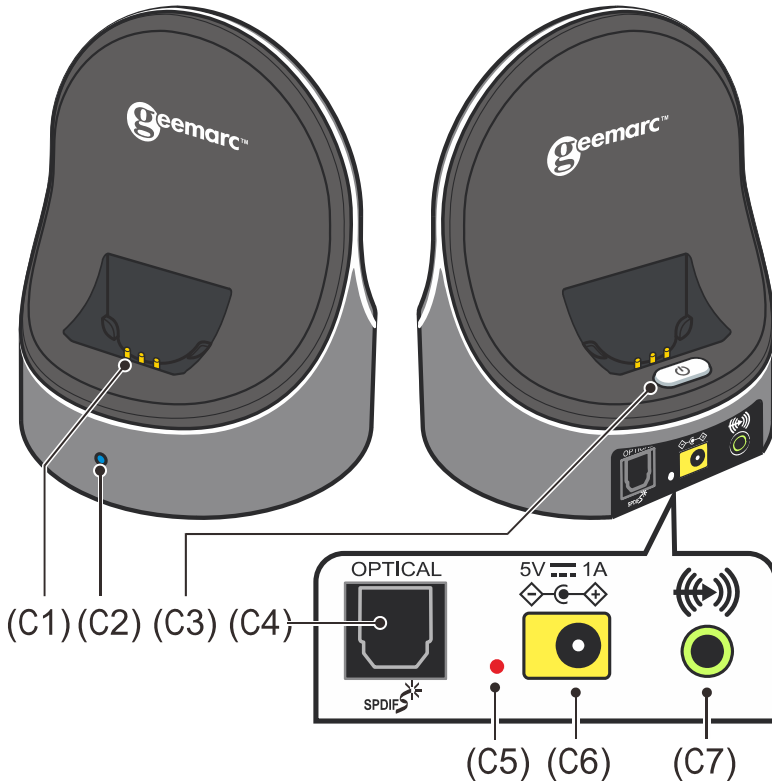

(C1) Charging Pins

(C2) Pair LED Indicator :

- **Blue Lights up** - Paired Headsets found;
- **Blue Slow flashing** - Not paired devices found;
- **Blue Fast flashing** - Not paired devices found or No sound input for more than 10 minutes.

(C3) Power Switch

(C4) Optical Digital Audio In (for the optical version only)

(C5) Power ON/OFF LED Indicator: **Red** = Power ON.

(C6) DC In Socket 5V/1A

(C7) Analogue Audio In

## INSTALLATION

### Transmitter

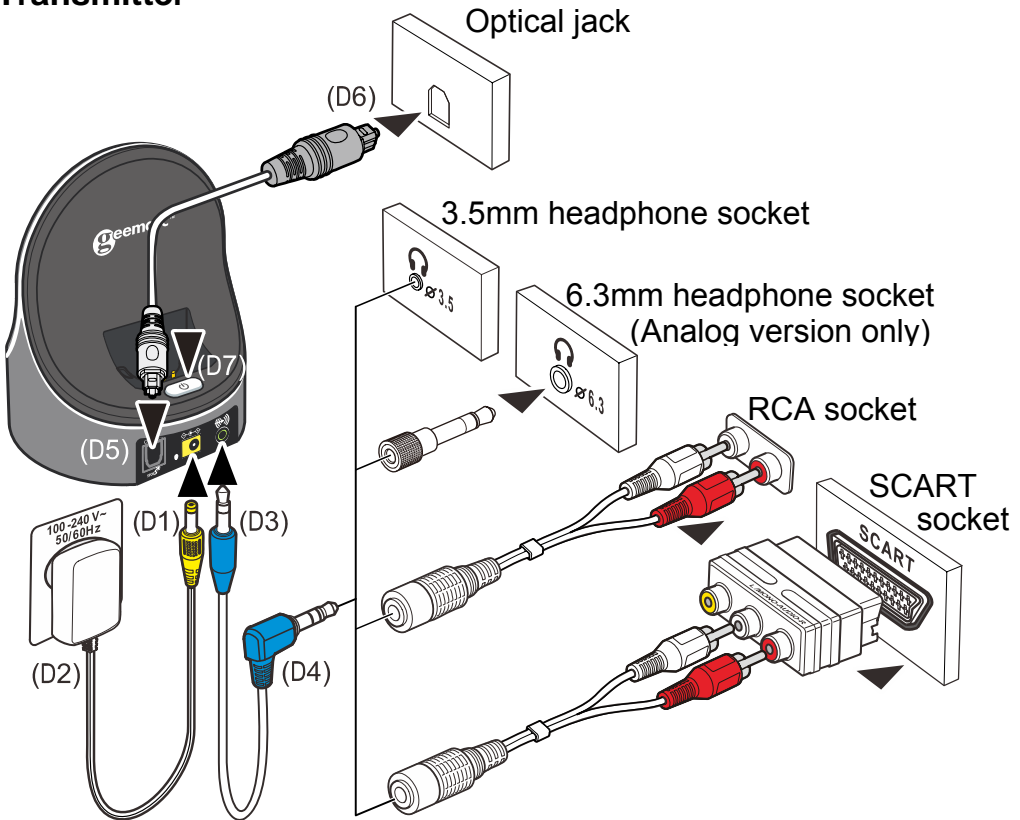

- (D1) Connect the Power Supply to yellow Socket (5V/1A) located on the Charge Cradle rear panel.
- (D2) Connect the Power Supply to an electricity socket (100-240V ~ 50/60Hz).
- (D3) Connect one end of the Audio Cable to Analogue Audio Input in the rear panel of the Charge Cradle.
- (D4) Connect the other end of the Audio Cable to your Audio Source (e.g. TV set, Hi-Fi system, MP3 or iPod).

If your Audio Source does not have a suitable socket for the Audio Cable's 3.5 mm stereo plug, then use one of the Adapters provided:

# INSTALLATION

- RCA Adapter Cable (Option and Analog version only);
- 3.5 mm to 6.3 mm Adapter Plug (Option and Analog version only);
- SCART Adapter (Option and Analog version only);

For CL7370 Digital version, you can also:

- (D5) Connect one end of the **Toslink Cable** to Digital Audio Input in the rear panel of the Charge Cradle.
- (D6) Connect the other end of the **Toslink Cable** to your Audio Source with optical digital audio output(e.g. TV set, Hi-Fi system).
- (D7) On the rear side of the Charging Cradle, press the Power ON/OFF button to Switch to ON, the red LED will light up.

**Note:** When using CL7370 Digital Version with a digital audio input signal the TV audio output must be set to PCM mode. CL7370 is not compatible with Dolby Digital. The PCM setting can normally be done using the audio menu settings of the TV. Please refer to your TV/DVD/Satellite/Cable Box user's manual for instructions for setting to PCM mode.

## Headset

Make sure the built-in Battery inside the Headset is fully charged for the first use  
– see Initial Operation below.

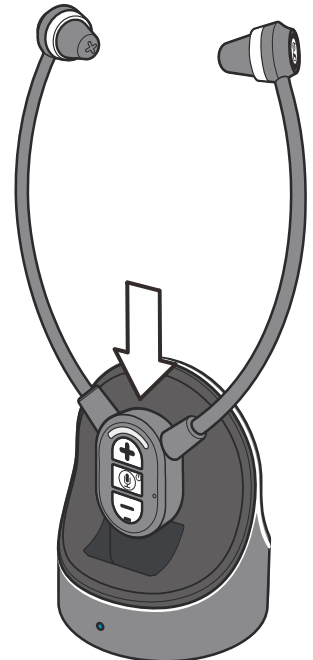

## OPERATION

### Initial Operation

1. Make sure the CL7370 is plugged into the main.
2. Switch ON the CL7370 – at the back of the Charging Cradle (see figure (1) at right).
3. Place the Headset in the Charging Cradle for at least three hours to allow it to fully charge.
  - The Headset is switched OFF automatically when it is placed in the Charging Cradle.
  - The LED Indicator shows red during charging.
  - It will glow green when the battery is fully charged (see figure (2) at right).
4. After three hours and when the charging LED has turned green, you can proceed to the Routine Operation.

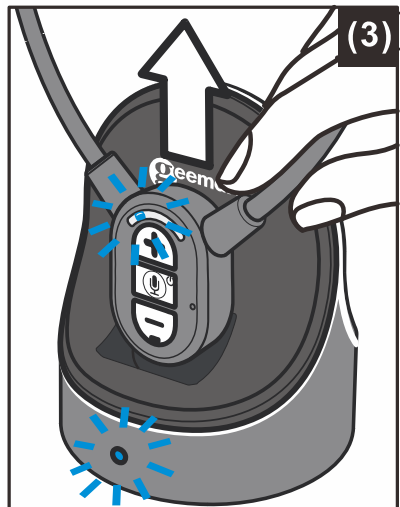
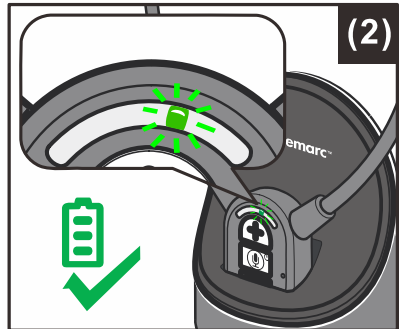
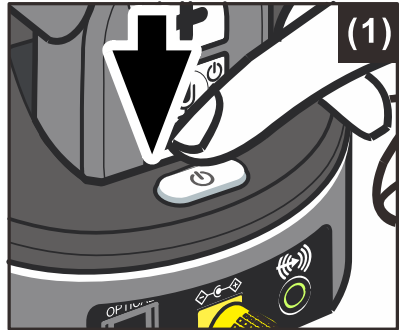

### Routine Operation

1. Turn ON the Audio Source (TV set or audio device) where the Transmitter is connected to.
2. Take out the Headset Receiver from the charging Cradle, headset will turn ON automatically, (if not, short press the MIC button to power on the Headset), The blue signal LED Indicator both on Base and headset will glow continuously. (see figure (3) at right).

# OPERATION

3. Adjust the Volume to the desired sound level (see figure (4) at right), Press '+' button to increase volume and '-' button to decrease volume. Headset beeps when volume reaches maximum or minimum. then fit the Earbuds in your ears.

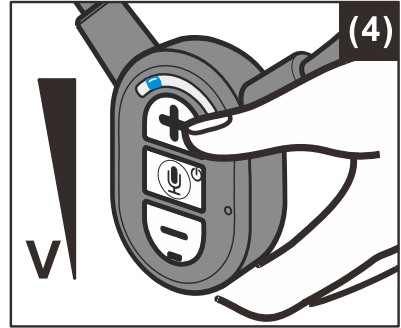

**NOTE:** Make sure the volume on your Audio Source (TV set or other audio device) is turned up to at least half of its full volume to get good sound quality in your Earbuds.



## NOTE:

1. The Headset will turn off automatically if there is no audio signal from the audio source (TV set, etc.) or a too weak signal within about **15 minutes**, if you want to resume headset in this case, you can short press the MIC Button to Power on the headset.
2. Auto Power OFF Headset simply by replacing the Headset in its Charging Cradle.
3. Auto Power ON Headset simply by taking the Headset from its Charging Cradle. - This is only available when a Power on headset is replaced into Charging Cradle.
4. If you place a power off headset into its charging cradle, the headset can not be Powered on automatically when you take it again. In this case, just short press MIC button to Power on headset.

## Controlling the Tone (Bass & Treble)

You can adjust the tone of the audio you are listening and to enhance your listening pleasure by amplifying either the Treble or the Bass in the Headset Receiver.

Press the Tone Button on the rear of headset to switch cyclically between:

1. Enhanced treble,
2. Enhanced bass,
3. Flat tone (bass and treble equally enhanced).

Headset beeps when tone adjustment reaches the default setting (the flat tone).

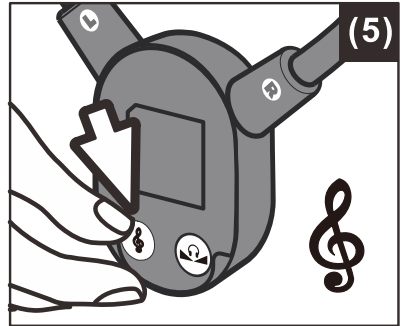

## Adjusting the Sound Balance (left-right)

You can adjust the sound to suit your hearing in each ear. With the Headset on, Press the Balance Button on the rear of headset to enter balance mode. Press '+' button to decrease sound on RIGHT side. Press '-' button to decrease sound on LEFT side. (see figure (6) at right).

Headset beeps when balance reaches maximum, middle or minimum. Press Balance Button again to exit balance mode and come back to the normal mode.

**Note: if you forget to exit balance mode for more than 6 seconds, unit will come back to normal mode automatically.**

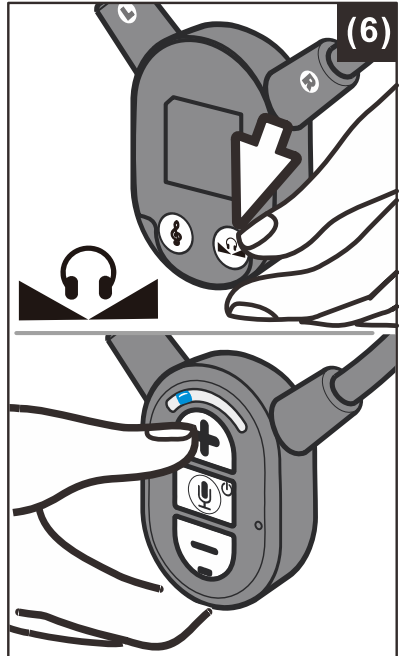

# OPERATION

## Using the MIC Button for Conversation

You can switch from Listening mode to Conversation mode without having to take off the Headset.

To talk or listen someone:

1. Short Press the MIC button (see figure (7) at right). This will shut off the Audio Source and the Headset will become an amplifier by activating the Microphone.
2. To resume listening to your audio device, Short press the Mute button again. The microphone will be shut off and the audio will resume.

**Note:** long press the Mute button will power off the headset, simply short press the Mute button again to resume headset.

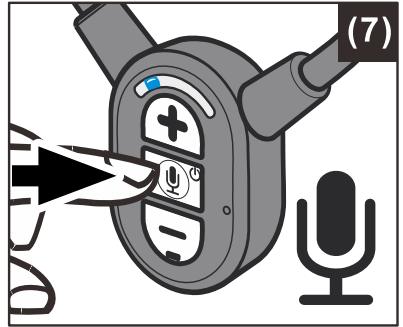

## Charging the Battery

1. The Headset Receiver will beep when the battery level is low. At this stage there are about 20 minutes of operating time before the Headset will switch off. Recharge the battery.
2. Place the Headphone on the Charging Cradle (see figure (8) at right), make sure the charge contact touches the charge pins on the Charging Cradle.
3. The Charging process starts automatically.
  - The LED Indicator glows red during charging.
  - It will glow green after the battery is fully charged.

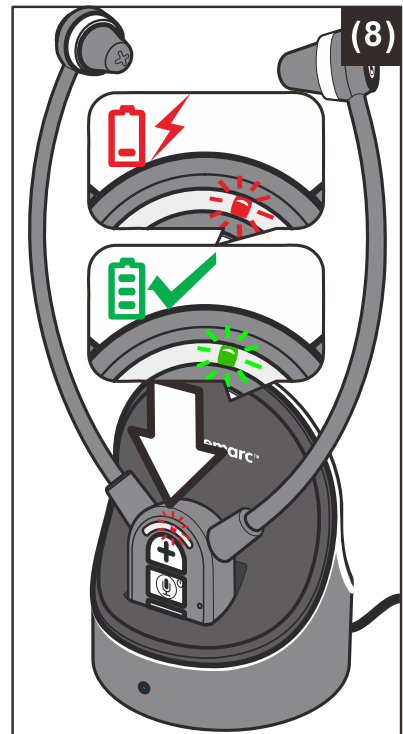



## WARNING:

The battery must not be exposed to excessive heat such as sunshine, fire etc.

Do not attempt to replace the original rechargeable battery.

The battery must always be fully charged before first use. An initial 3 hours charge is required to guarantee an acceptable service life for the rechargeable battery.

Excessive sound pressure from earphones and headphones can cause hearing loss.

## IMPORTANT:

This unit should be operated with built-in rechargeable battery only. When replacing the battery or when disposing of the unit, always comply with applicable laws relating to the disposal of battery. Please place them in a proper disposal container to ensure that they are eliminated safely and in an environmentally friendly way.

## Pairing extra Headsets:

**Note :** Up to 4 Headsets can be paired to each Base.

To pair Base and headset ensure batteries are fully charged and the Base is connected to mains power (see section "**Initial Operation**" for headset charging). Proceed as follows:

1. Power off all the paired headsets. Switch off the Base. (by pressing 3 seconds the rear button of the base).
2. Take and Power ON the extra Headset, Press and hold down the "**TONE**" and "**BALANCE**" buttons at same time until the

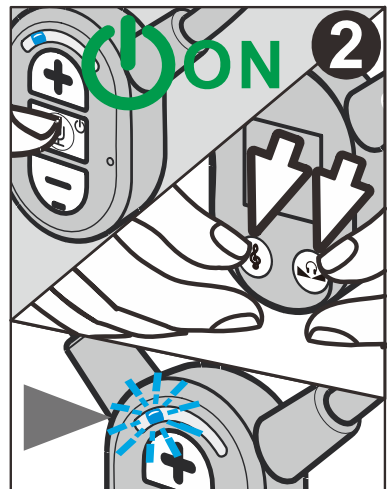
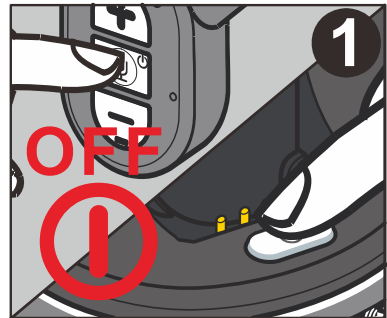

# OPERATION

**blue** LED in the headset front is in fast flashing, then release the buttons.

3. Switch **ON** the base and the **blue** LED start fast flashing, When the **blue** LED stop flashing and lights up, the pairing is complete automatically.

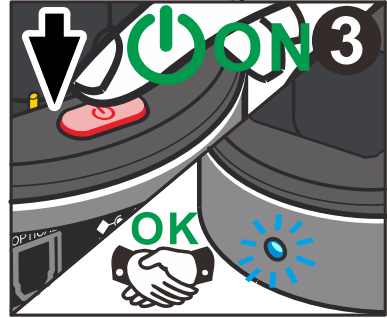

## Note:

1. After the Headset enter pairing mode, you must switch on the base as soon as possible (within 20 seconds).
2. If the pairing process is not successful, please power off the headset and base, then repeat the pairing process again.

The extra headset can be charged in the rear charging cradle on the base, in this case, you should remove the cover of rear charging cradle and place the extra headset on the rear charging cradle. See figures (9)

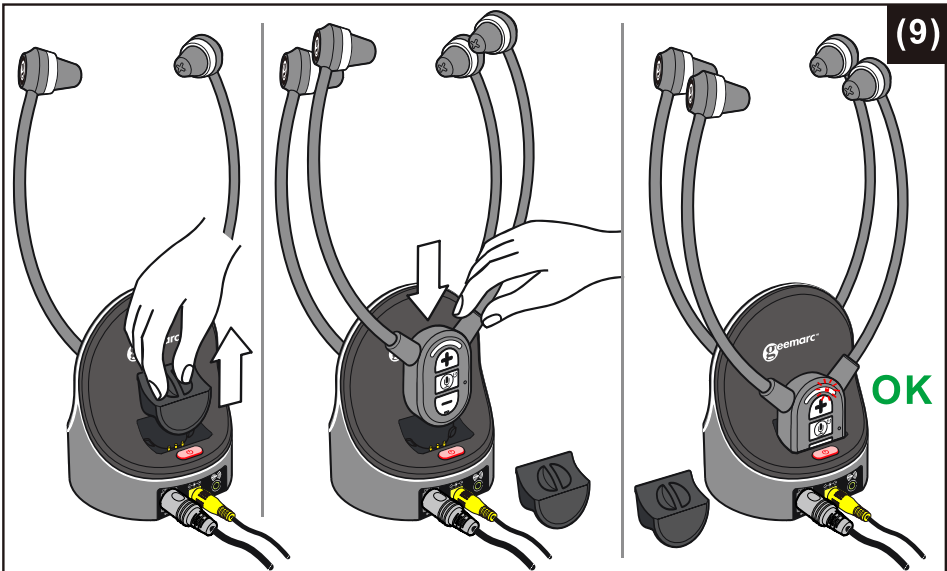



## TROUBLESHOOTING

---

### No Sound

- Ensure the power supply is properly plugged into the electricity socket and that its cable is properly connected to yellow connector 5V/1A on the Charge Cradle.
- Ensure that the Headset is switched ON (fix Blue Led).
- Check the state of the Battery charging in the Headset – place it in the Charge Cradle and recharge the battery until the Battery Charge LED turns green.
- Ensure that the TV set, Hi-Fi system or audio component is switched ON and set to a channel that broadcasts an audio signal.
- Ensure that the volume on the connected audio component is turned up to at least half its full volume.
- The connected audio/video equipment may not be in playback mode. Start playback on by the equipment.
- Use the + button on the Headset to turn up the volume.

### Distortion

- The battery inside Headset may need charging. Recharge the battery.
- The Headset may be too far away from the transmitter inside the Charge Cradle. Bring them closer together.
- The audio signal input level from the audio source is too low. Increase the volume at the audio source.

# Cleaning & Maintenance . Spare/replacement parts . Customer support

## Cleaning & Maintenance

---

**Note: DO NOT** use alcohol, chemical or spirit based cleaning agents.

Wipe Base and Headset clean with a damp cloth.

Regularly remove (see figure (10) at right) and clean 'Ear pads' with warm soapy water.

Two types of ear pad are supplied, select the most suited to yourself.

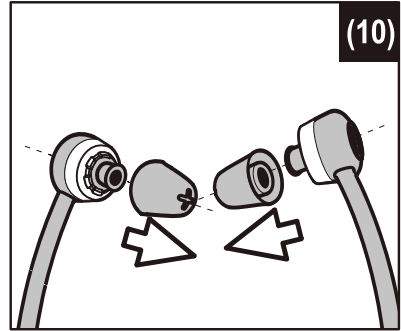

## Spare/replacement parts

---

Spare parts are available from either the original place of purchase or by calling the Customer Helpline Telephone:

**01707 387602**

1. Additional Headsets
2. Ear pads

To replace the Headset battery, please contact Customer Support.

## Customer support

---

For product support and help, visit our website at **[www.geemarc.com](http://www.geemarc.com)**

E-mail : **[help@geemarc.com](mailto:help@geemarc.com)**

For our Customer Helpline Telephone: **01707 387602**

# GUARANTEE . UKCA DECLARATION . BATTERY WARNINGS

## GUARANTEE

---

From the moment your Geemarc CL7370 product is purchased, Geemarc guarantee it for the period of two years. During this time, all repairs or replacements (at our discretion) are free of charge. Should you experience a problem then contact our Helpline or visit our website at [www.geemarc.com](http://www.geemarc.com). The guarantee does not cover accidents, negligence or breakage to any parts. The product must not be tampered with or taken apart by anyone who is not an authorised Geemarc representative.

The Geemarc guarantee in no way limits your legal rights.

**Important:** YOUR RECEIPT IS PART OF YOUR GUARANTEE AND MUST BE RETAINED AND PRODUCED IN THE EVENT OF A WARRANTY CLAIM.

**Please note:** The guarantee applies to the United Kingdom only.

## UKCA DECLARATION

---

Geemarc Telecom SA hereby declares that this CL7370 is in compliance with the essential requirements and other relevant provisions of the Radio Equipment Directive 2014/53/UE.

*The declaration of conformity may be consulted at [www.geemarc.com](http://www.geemarc.com)*



## BATTERY WARNINGS

---

- **DO NOT** attempt to dismantle.
- **DO NOT** dispose of in fire.
- **DO NOT** swallow.
- Keep away from children.
- **DO NOT** short-circuit the Battery Contact terminals.
- Exhausted batteries are to be replaced only by a certified Geemarc service technician.
- **Caution:** Risk of explosion if battery is replaced incorrectly or if the wrong type of battery is used. Dispose of used batteries according to the instructions.



# DISPOSAL INFORMATION . FEATURES

## DISPOSAL INFORMATION

---



**Disposal of old electrical & electronic equipment  
(applicable in the European Union and other European  
countries with separate collection systems)**

The symbol on the product or its packaging indicates that this product may not be treated as household waste. Instead it should be handed over to the applicable collection point for the recycling of electrical and electronic equipment.

By ensuring this product is disposed of correctly, you will help prevent potential negative consequences for the environment and human health, which could otherwise be caused by inappropriate waste handling of this product.

For more detailed information about recycling this product, please contact your local council office, your household waste disposal service or the shop where the product was purchased.

## FEATURES:

---

1. Digital 2.4 GHZ AFHSS transmission (Adaptive Frequency Hopping)-CD sound quality!
2. 16 hopping channels.
3. Receiving amplification: up to 120dBspl.
4. Frequency response: 100- 16000Hz.
5. Operating indoor range up to 25 meters from the transmitter.
6. Continuous usage time: up to 6 hours.
7. Charged when you need it-Headset recharges itself when placed back into Base unit.
8. Headset Auto Power OFF when placed back into Base unit.
9. Headset Auto Power ON when took from the Base unit.
10. 3.5mm audio input stereo jack access in Base unit.
11. Optical Digital audio input jack access in Base unit (Option).
12. Weight : 50g.

# TECHNICAL SPECIFICATIONS

## TECHNICAL SPECIFICATIONS

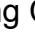
Transmission mode	: <b>Digital 2.4GHz AFHSS</b> (Adaptive Frequency Hopping) – CD sound quality!
Carrier frequency	: 2.4GHz
Frequency response	: 100 Hz – 16000 Hz
Hopping channels	: 16
Receiving amplification	: up to 120 dBspl
Range	: Up to 25 meters (open area)
Headset weight	: 50 grams
Operating voltage	: Charging Cradle: DC 5V  1.0A, 5W : Headset: 3.7V, 500mAh Lithium Polymer Battery
Battery operating Time	: Up to 6 Hours
Radio Frequency Power	: <20 dbm



For product support and help visit our website at

**[www.geemarc.com](http://www.geemarc.com)**

Parc de l'Etoile, 2 Rue Galilée, 59791 Grande-Synthe, France

E-mail : **[help@geemarc.com](mailto:help@geemarc.com)**

Telephone : **01707 387602**

lines are open 09h00 to 16h00 Mon to Fri

This product is made in China To Geemarc Telecom



© 02 August, 2021



UGCL7370\_En\_v1.0

