



USER GUIDE

!!! Please refer to our website: www.geemarc.com for an up to date user guide, as there may be important updates and changes you need to be aware of !!!

What's in the box

- Wake & Shake Light
- Power supply unit
- This instructions guide
- 1 Shaker

Signs and symbols

The following symbols appear in the instructions for use and on the battery door.

- WARNING :** Warning instruction indicating a risk of injury or damage to health.
- IMPORTANT :** Safety note indicating possible damage to the device/ accessory.
- NOTE :** Note on important information.

1. Safety notes

- WARNING**
- Only operate the device with the power supply unit provided and the mains voltage specified on the power supply unit.
- Do not operate the device if it is visibly damaged.
- In the event of defects or operational faults, switch the device off immediately and disconnect it from the mains socket.
- Do not pull on the mains cable or on the device to disconnect the power supply unit from the socket.
- Never plug in or unplug the power supply unit when you have wet hands.
- Never hold or carry the device by the mains cable.
- Keep packaging material away from children (risk of suffocation).
- Arrange the mains cable so that no-one will trip over it.
- Never use the device in proximity to moisture.

2. Intended use

The Wake-up Light wakes you from sleep in a gentle and natural manner. The LED light gradually becomes brighter like a rising sun, allowing your eyes to slowly become accustomed to the light conditions and your body to gently prepare itself for waking up. The light intensity can be set to your personal preferences. Along with the simulated sunrise, you can set an acoustic alarm to help you wake up. Choose between the radio, a beep or five natural sounds or you can select shaker vibration. The Wake-up Light provides a rested and pleasant start to your day.

3. Device functions:

- Clock display
- Wake-up function with simulated sunrises and alarm
- Two alarms selection Simulated sunrise
- Radio
- 5 natural sounds
- Shaker vibrations Goodnight function
- LED light can be used as a lamp
- Mood light function.
- USB Smart Phone charger.
- MP3 Input.

WARNING

- The device is only intended for the purpose described in these instructions for use. The manufacturer is not liable for damage resulting from improper or careless use.

4. Initial use

- Remove the packaging material.
- Check that all parts listed are present.
- Check the device, mains plug and cable for damage. Place the device on a firm, even surface.
- Position the device approx, 40 cm from your head.
- Remove the battery compartment cover on the rear of the device and insert the 4 x AA batteries with corrected polarity battery symbol on compartment. The battery supplies power to the device in the event of a power failure and is not intended to be used as a permanent power supply.
- Plug the power supply connector into the power supply socket on the underside of the device.
- Insert the main plug into a suitable socket. The time will display and you can set the hour format.

NOTE: All settings will go back to normal time mode after 6 seconds, press the TONE button to exit if you want to exit the settings.

5. Unit description

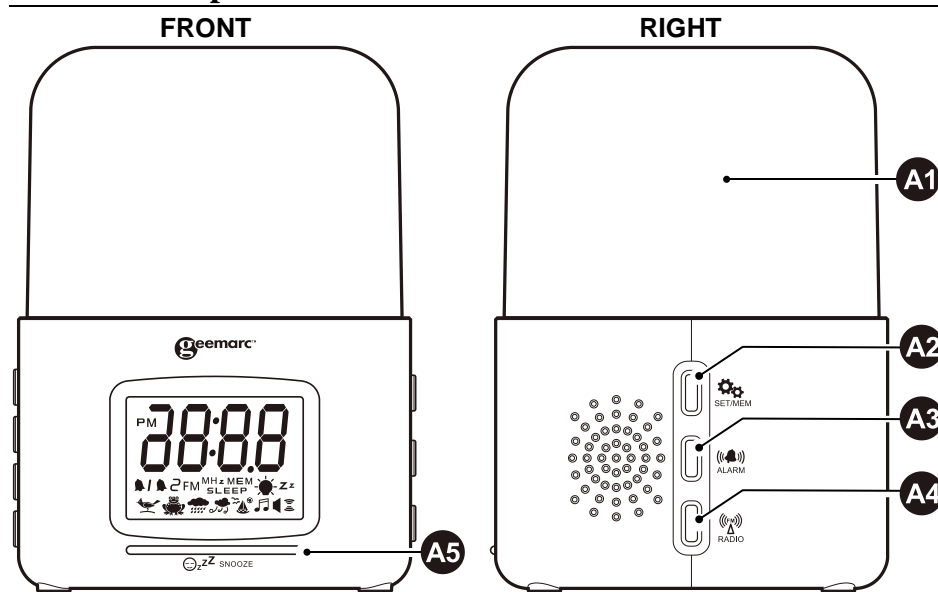

- A1.** LED light
- A2.** SET/MEM button (for adjusting time and radio station storage)
- A3.** ALARM button (for adjusting the alarm time n alarm source)
- A4.** RADIO button (for activating the radio function)
- A5.** SNOOZE button (for activating snooze function, goodnight function or Wake up light function)

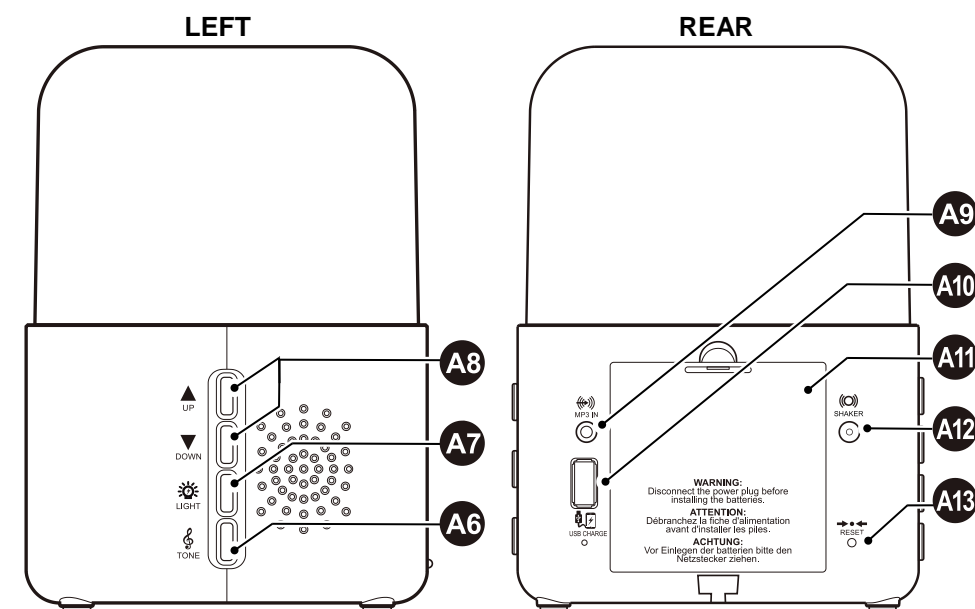

- A6.** TONE button (for adjusting the volume and selecting alarm tone)
- A7.** LIGHT button (for switching on/off the light and adjusting the back light and color mood light selecting)
- A8.** UP/Down button (For adjusting time, alarm and volume)
- A9.** Aux Input Jack (For connecting the MP3 input)
- A10.** USB port (for charging the smart phone)
- A11.** Battery compartment with cover
- A12.** Shaker Jack (for connecting the shaker)
- A13.** Reset-Hole (Resetting the device to factory settings)
- A14.** Switching power adaptor (Select the good adaptor)

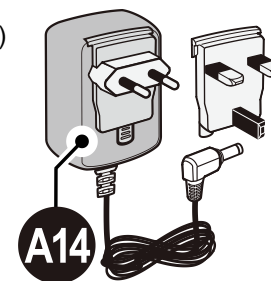

6. Display description

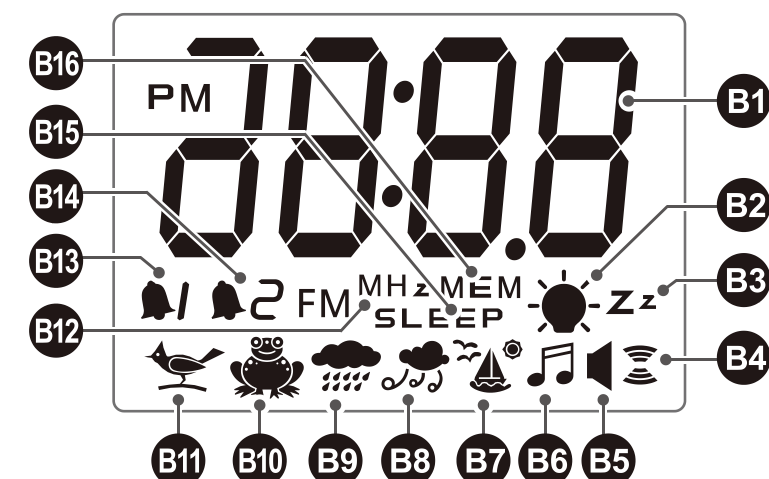

- B1.** Time / alarm time or radio frequency
- B2.** Light symbol
- B3.** Good night
- B4.** Shaker
- B5.** Beep Alarm sound
- B6.** Radio
- B7.** Seagull sound
- B8.** Wind sound
- B9.** Rain forest sound
- B10.** Frog sound
- B11.** Bird sound
- B12.** FM radio frequency
- B13.** Alarm 1
- B14.** Alarm 2
- B15.** Sleep
- B16.** Radio station memory

7. Operation

NOTE: All settings will go back to normal time mode after 6 seconds, press the TONE button to exit the settings.

7.1 Setting the time

• Press the SET MEM button, the hour will flash.	12:00
• Press the Up button to set the hour.	12
• Press the DOWN button to set the minute	00
• Press the SET MEM button, Choose between 12 and 24 hour format with the UP / DOWN buttons.	12 hr
• Press the SET MEM button, Choose Snooze time 5 to 30 minutes at 5 minutes steps (Default is 5 minutes) with the UP / DOWN buttons.	Zz 05
• Press the SET MEM button, Time is set.	12:00

7.2 Setting and activating alarm

<ul style="list-style-type: none"> • Press the ALARM button once, Alarm 1 will be set. • Press the ALARM button twice, Alarm 2 will be set. • Press the ALARM button until OFF fade away. Setting alarm time by pressing UP or DOWN button. 	
<ul style="list-style-type: none"> • Press the SET MEM button each times. Selecting the alarm sound: The bird, frog, rain forest, wind, seagull, radio or beep will display a sound. 	
• Press the ALARM button, the alarm sound is set.	12:00
• Press the SET MEM button, selecting shaker vibrator .	
• Press the ALARM button, Alarm is set and Alarm 1 icon lit up if selected. If Alarm 2 is selected, Alarm 2 icon lit up.	

NOTE: During the Alarm, press the alarm button to stop it permanently.

7.3 Setting wake up light

• Press and hold SNOOZE wake'n shake display shown. Setting the wake'n shake light function. Default wake n shaker light is OFF ,	
• Press the UP or DOWN button, Selecting the wake'n shake light time to 15 or 30 minutes. Wake'n shaker light is set and will be lit up gradually before the alarm time.	15 30

7.4 Deactivating the alarm

<ul style="list-style-type: none"> • Press the ALARM button once, Alarm 1 will be deactivated. • Press the ALARM button twice, Alarm 2 will be deactivated. 	
• Press the ALARM button until OFF showed, Alarm is deactivated.	OFF

7.5 Deactivating the alarm

• Press the ALARM button until OFF fades away. Alarm is activated again.	
--	--

NOTE: The wake'n shake light will be deactivated when alarm is **OFF**.

7.6 Alarm Tone

• Press the TONE button at normal Time mode. Setting the Tone in 10 frequency. Default Tone is #5 frequency.	F05
• Press the UP or DOWN button. Selecting desired tone frequency in alarm.	

Desire tone frequency is set.

7.7 Alarm Volume

• Press the UP or DOWN button at normal Time mode. Selecting the volume of alarm. Default volume is U08 and maximum level is U20.	U08
---	------------

7.8 Connecting Shaker Vibrator

• Connect shaker vibrator at rear jack .	
--	--

7.9 Light Function

• Press the LIGHT button at normal Time mode. User device as normal lamp. Light will be lit up gradually with the light icon on.	
• Press the UP or DOWN button adjusting the light intensity. The default intensity L07 shown and the max intensity is L15.	L07
• Press the LIGHT button again. To switch OFF the light and light icon will fade.	

7.10 Radio Function

• Press the RADIO button at normal Time mode. The radio frequency currently set will appear on the display.	
• Press the UP or DOWN button. Setting the desired radio frequency. Tip: to start the automatic scan, press and hold the UP or DOWN button briefly and then release it again.	
• Press the TONE button. The default Volume U06 will show on the display.	U06
• Press the UP or DOWN button. Adjusting the volume, and the max volume is U12.	

7.11 Preset Radio Station / Listening Preset Radio Station

• Press the SET MEM button until S01 shows. The current radio station is stored in S01.	S01
• Press the SET MEM button until S02 shows. The new desired radio station is stored in S02. Max can be stored 10 radio stations.	S02
• Press the SET MEM button each times. Listening preset radio stations and starts sequence S01 > S02 > S03.	

7.12 Goodnight function

• Press the SNOOZE button until OFF SLEEP shown.	OFF SLEEP
• Press the UP or DOWN button to select desired switch off time from 5 minutes to 90 minutes.	
• Press the TONE button exit or wait 6 seconds. The selected switch off time will start to count with the SLEEP icon flashing.	
• Press the SNOOZE button until the remaining time shown. This function automatically switches off the radio or MP3 or a natural sound after a set period of time.	

7.13 Display Illumination

• Press the LIGHT button until U03 shown at normal time mode. Adjusting the display brightness by press the Light button each times. Brightness changes U03>U04>U01>U02, Max brightness is U04.	U03
---	------------

7.14 MP3 Playback Function

<ul style="list-style-type: none"> • Press the RADIO button. • Connect the MP3 to the rear jack by cable. • AU shown on display. 	AU
<ul style="list-style-type: none"> • Press the TONE button. The default Volume U06 will shown on the display. • Press the UP or DOWN button. Adjusting the volume, and the max volume is U06. 	U06

7.15 Smart Phone Charger Function

• Connect the Smart Phone with USB cable to rear USB socket to charge the Smart Phone.	
---	--

8. Cleaning and maintenance

- Clean the device with a dry cloth.
- Do not use any abrasive cleaning products.
- Protect the device from knocks, damp, dust, chemicals, drastic changes in temperature, and nearby sources of heat (ovens, heaters).

9. Technical Data

- **Dimensions:** 120 x 170 x 120mm
- **Weight:** approx. 508g
- **Voltage supply:** 100-240V; 50/60Hz; 0.7A
- Protection class II
- For indoor use only
- **Radiofrequency range:** 87.5-108.0 MHz FM
- **Illuminance:** 300lux

10. GUARANTEE

From the moment your Geemarc product is purchased, Geemarc guarantee it for the period of two years. During this time, all repairs or replacements (at our discretion) are free of charge. Should you experience a problem then contact our help line or visit our website at www.geemarc.com.

The guarantee does not cover accidents, negligence or breakages to any parts. The product must not be tampered with or taken apart by anyone who is not an authorized Geemarc representative.

The Geemarc guarantee in no way limits your legal rights.

IMPORTANT: YOUR RECEIPT IS PART OF YOUR GUARANTEE AND MUST BE RETAINED AND PRODUCED IN THE EVENT OF A WARRANTY CLAIM.

Please note: The guarantee applies to the United Kingdom only.

11. DECLARATIONS:

CE Directives

Geemarc Telecom SA hereby declares that this product is in compliance with the essential requirements and other relevant provisions of the RED 2014/53/UE.

The CE declaration of conformity may be consulted at www.geemarc.com

Recycling Directives

The WEEE (Waste Electrical and Electronic Equipment) has been put in place for the products at the end of their useful life are recycled in the best way.

When this product is finished with, please do not put it in your domestic waste bin. Please use one of the following disposal options:

- Remove the batteries and deposit them in an appropriate WEEE skip. Deposit the product in an appropriate WEEE skip.
- Or, hand the old product to the retailer. If you purchase a new one, they should accept it.

Thus if you respect these instructions you ensure human health and environmental protection.



For product support and help visit our website at www.geemarc.com
United Kingdom: 5B Swallow Court, Swallowfields, Welwyn Garden City,
Hertfordshire, AL7 1SB, UK

telephone **01707 387602** or fax **01707 832529**