

Alarm Clock with shaker

Réveil avec vibreur

Wecker mit Vibrationsalarm



**BACKUP BATTERY INSTALLATION**

Your clock requires one AA battery (not included) to provide backup power to the clock in the event of a temporary power interruption.

1. Place your unit face down on a flat and soft surface.
2. Open the battery door located on the bottom of the unit.
3. Insert one new AA battery into the battery compartment by observing the correct "+" and "-" polarity.
4. Close the battery door.

It is not necessary to insert a back-up battery for the clock to function; however, **The backup battery will keep the time running in the event of a power cut or the AC/DC adaptor being unplugged. If AC power is interrupted, the alarm and backlight will not function.**

Check the battery condition after one year, replacing old battery if need. A leaking battery can destroy your clock.

**CAUTION :** Danger of explosion if battery is incorrectly replaced. Replace only with the same or equivalent type.

**WARNING :** Battery shall not be exposed to excessive heat such as sunshine, fire or the like.

**TO SET TIME**

Rotate the knob counter-clockwise to set your clock to the current time.

**Remarks:** Please don't rotate knob or dials clockwise it may damage the clock movement.

**SETTING ALARM TIME (default at 6:00)**

Rotate the longer alarm knob counter-clockwise to set the alarm hand to your desired alarm time. Each inner segment or tick stands for 12 minutes.

For minimal alarm time tolerance, position the alarm hand precisely by pointing to the alarm tick you want.

**TO SELECT ALARM ON/OFF**

To turn on the alarm function, anytime slide button to **ON** position which indicate a green inlay.

To turn off the alarm function, anytime slide button to **OFF** position.

**TO SELECT ALARM TONE FREQUENCY**

Slide button to position 1 or 2 or 3 to select alarm frequency tone during alarm active.

- 1 (low tone, 800 Hz)
- 2 (mid tone, 1 KHz)
- 3 (high tone, 1.5 KHz)

**TO SELECT ALARM VOLUME**

Slide button to position **HI** or **MED** or **LO** or **OFF** to select alarm buzzer sound level during alarm active.

**TO SELECT VIBRATOR HI/LO**

Slide button to position **HI** or **LO** to select vibrator at high or low level during alarm active.

If you don't want to use the vibrator, don't connect the vibrator adapter.

**TO STOP THE ALARM FUNCTION**

When alarm active, slide button to **OFF** position.

**TO USE SNOOZE**

When alarm is sounding, press once, the alarm will be stopped temporarily. Alarm will come on again after 5 minutes.

**TO USE THE HI-MED-LO DIMMER (TIME DIGITS)**

There is a 3-level brightness control for the backlight. Press to adjust the brightness (**HI** / **MED** / **LO**) of the backlight. This can only be done when the unit is not sounding.

**TO USE THE RING OF LED LIGHT**

1. Press and hold button to turn on the ring of LED light, the brightness level of LED ring (**Hi-Med-Lo**) corresponds to the time display brightness (**Hi-Med-Lo**).
2. When the LED ring lights up, press button one at a time to adjust time display brightness and LED ring brightness accordingly.
3. Press and hold button to turn off the ring of LED light..

**TO CHARGE YOUR MOBILE PHONE WITH USB PORT**

Connect the charging cable (not included) of your mobile device to the A-type USB port at the back of the unit, then connect the other end to your mobile device. The clock will charge the mobile device automatically.

**Note:**

1. Make sure the cable supplied with your mobile phone is used for charging.
2. Make sure the original adaptor enclosed with your clock radio (5V 1.2A) is

being used to power your clock. Using other adaptors may not charge your phone.

3. It is not possible to charge an iPad® or notepad from the USB socket on this clock.

4. When the alarms are sounding/active you can not charge phones etc using the USB port.

**TROUBLE SHOOTING**

If your clock does not function properly, which maybe caused by electro-static discharge or other interference, unplug the DC jack to disconnect the AC power (and remove the backup battery), leave it for few minutes and then plug in the adaptor to repower your clock.

**CARE OF YOUR PRODUCT**

1. Place your clock on a stable surface, away from sources of direct sunlight or excessive heat or moisture.
2. Protect your furniture when placing your unit on a natural wood and lacquered finish by using a cloth or protective material between the unit and the furniture.
3. Clean your unit with a soft cloth moistened only with mild soap and water. Stronger agents such as benzene, thinners or similar materials can damage the surface of the unit. Make sure the unit is unplugged before cleaning.
4. Remove the back-up battery if the clock is not going to be used for a month or longer to prevent possible corrosion. Should the battery compartment become corroded or dirty, clean the compartment thoroughly and replace the battery.

**SPECIFICATIONS**

Default settings	Time	10:10
	Alarm	6:00
	Alarm ON/OFF	OFF
	Alarm sound frequency	1 (800Hz)
	Alarm Volume	OFF
	Alarm Vibration level	HI
	Snooze duration	5 minutes

**GUARANTEE**

From the moment your Geemarc product is purchased, Geemarc guarantee it for the period of two years. During this time, all repairs or replacements (at our discretion) are free of charge. Should you experience a problem then contact our help line or visit our website at [www.geemarc.com](http://www.geemarc.com).

The guarantee does not cover accidents, negligence or breakages to any parts. The product must not be tampered with or taken apart by anyone who is not an authorized Geemarc representative.

The Geemarc guarantee in no way limits your legal rights.

**IMPORTANT: YOUR RECEIPT IS PART OF YOUR GUARANTEE AND MUST BE RETAINED AND PRODUCED IN THE EVENT OF A WARRANTY CLAIM.**

**Please note: The guarantee applies to the United Kingdom only.**

**DECLARATIONS:**

**UKCA Directives:** Geemarc Telecom SA hereby declares that this Wake 'n' shake Vintage is in compliance with the UKCA Directive requirements.

The UKCA declaration of conformity may be consulted at [www.geemarc.com](http://www.geemarc.com)

**Electrical connection:** The apparatus is designed to operate from a 230V 50Hz supply only. (Classified as hazardous voltage according to EN62368-1 standard). The apparatus does not incorporate an integral power on/off switch. To switch off the apparatus, disconnect the power adaptor.

When installing the apparatus, ensure that the mains power socket is readily accessible.

**Recycling Directives:** The WEEE (Waste Electrical and Electronic Equipment) has been put in place for the products at the end of their useful life are recycled in the best way.

When this product is finished with, please do not put it in your domestic waste bin. Please use one of the following disposal options:

- Remove the batteries and deposit them in an appropriate WEEE skip. Deposit the product in an appropriate WEEE skip.
- Or, hand the old product to the retailer. If you purchase a new one, they should accept it.

Thus if you respect these instructions you ensure human health and environmental protection.



For product support and help visit our website at [www.geemarc.com](http://www.geemarc.com)

E-mail: [help@geemarc.com](mailto:help@geemarc.com)

telephone 01707 387602

lines are open 09h00 to 16h00 Mon to Fri

Parc de l'Etoile, 2 Rue Gallée, 59791 Grande-Synthe, France

This product is made in China To Geemarc Telecom

**Fr**

**MANUEL D'UTILISATION**

!!! Veuillez consulter notre site Web : [www.geemarc.com](http://www.geemarc.com) car il peut y avoir des mises à jour importantes et changement dont vous devez être conscient !!!

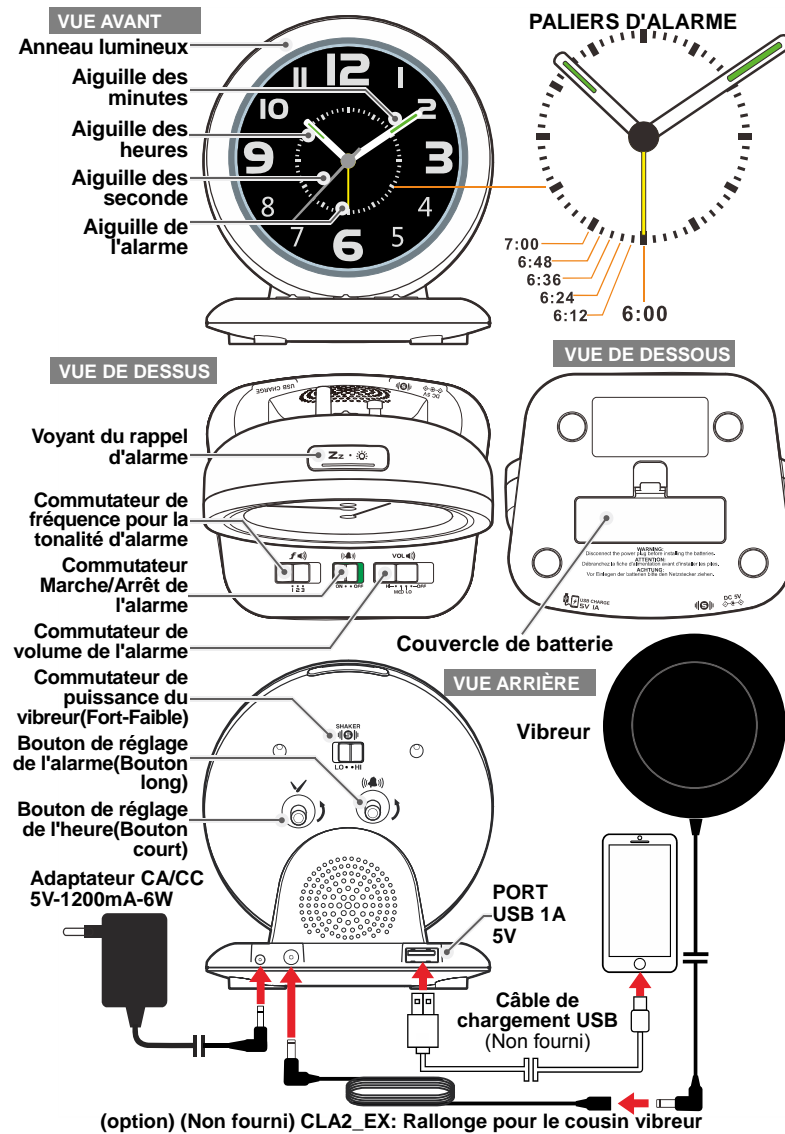

(option) (Non fourni) CLA2\_EX: Rallonge pour le cousin vibreur

**INSTALLATION**  
Branchez l'adaptateur AC/DC dans une prise de courant, puis branchez l'autre coté à l'arrière de l'appareil. Votre réveil est prêt à fonctionner. La prise doit se trouver à proximité de l'équipement et être facilement accessible.

**INSTALLATION DE LA BATTERIE DE SECOURS**

Votre réveil nécessite 1 batterie AA (non incluse) pour lui fournir une alimentation de secours en cas de coupure d'électricité.

1. Placez votre réveil face vers le bas sur une surface plane.
2. Ouvrez le couvercle du compartiment à pile situé sur la partie inférieure de l'appareil.
3. Insérez une nouvelle pile type AA dans le compartiment batterie en observant la polarité « + » et « - ».
4. Fermez le couvercle du compartiment à pile.

La batterie de secours permet de faire fonctionner l'horloge en cas de coupure de courant ou de débranchement de l'adaptateur CA/CC. Si l'électricité est interrompue, l'alarme et le rétro-éclairage ne fonctionneront pas.

Vérifiez l'état de la pile après un an, remplacez l'ancienne pile si nécessaire. Une pile qui fuit peut dégrader votre réveil.

**ATTENTION :** Risque d'explosion si la pile n'est pas correctement remise en place. Utilisez uniquement le même type de produit ou un type équivalent.

**AVERTISSEMENT :** La pile ne doit pas être exposée à une chaleur excessive telle que le rayonnement solaire, le feu ou autre.

**POUR RÉGLER L'HEURE**

Faites tourner le bouton dans le sens inverse des aiguilles d'une montre pour régler l'heure sur votre réveil.

**Remarque:** ne faites pas tourner le bouton ou le bouton dans le sens des aiguilles d'une montre, cela pourrait endommager le mouvement du réveil.

**SETTING ALARM TIME (default at 6:00)**

Faites tourner le bouton d'alarme le plus long dans le sens inverse des aiguilles d'une montre pour régler l'aiguille de l'alarme sur l'heure souhaitée. Chaque segment intérieur ou palier représente 12 minutes.

Pour une tolérance minimale de l'heure de l'alarme, positionnez l'aiguille de l'alarme avec précision en pointant sur le palier d'alarme souhaité.

**POUR SÉLECTIONNER LA MISE EN MARCHÉ/ARRÊT DE L'ALARME**

Pour activer la fonction alarme, mettez le bouton coulissant sur la position **ON** qui montre une inscription verte.

Pour désactiver la fonction alarme, mettez le bouton coulissant sur la position **OFF**.

**POUR SÉLECTIONNER LA FRÉQUENCE DE TONALITÉ**

**En USER GUIDE**

!!! Please refer to our website: [www.geemarc.com](http://www.geemarc.com) for an up to date user guide, as there may be important updates and changes you need to be aware of !!!

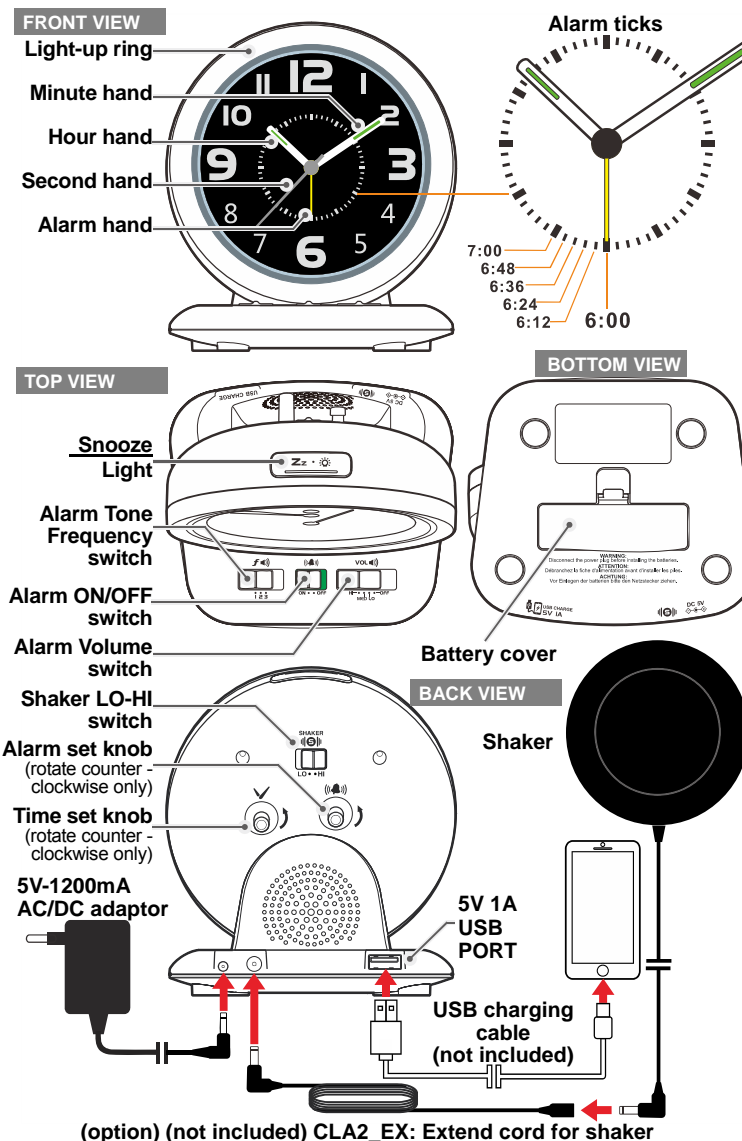

**INSTALLATION**

Plug the AC/DC adaptor to an AC household outlet, and then plug the DC jack to the back of the unit. Your clock is ready to work for you.

The socket-outlet shall be installed near the equipment and shall be easily accessible.

